



**MILES · PLATTS**

## TERMINALS

- All terminals & wire are now being converted to lead free
- Imperial type TBS 900 series to suit A and S ranges
- Metric type TBS 600 series to suit M range
- Solderability test to BS 2011 1981
- Round, square and serrated wire available
- Retention tests performed to assure connection integrity



Miles-Platts are technical moulders - we manufacture more than bobbins  
- please contact sales for details



# Terminals

# MILES · PLATTS

## TBS 600 RANGE

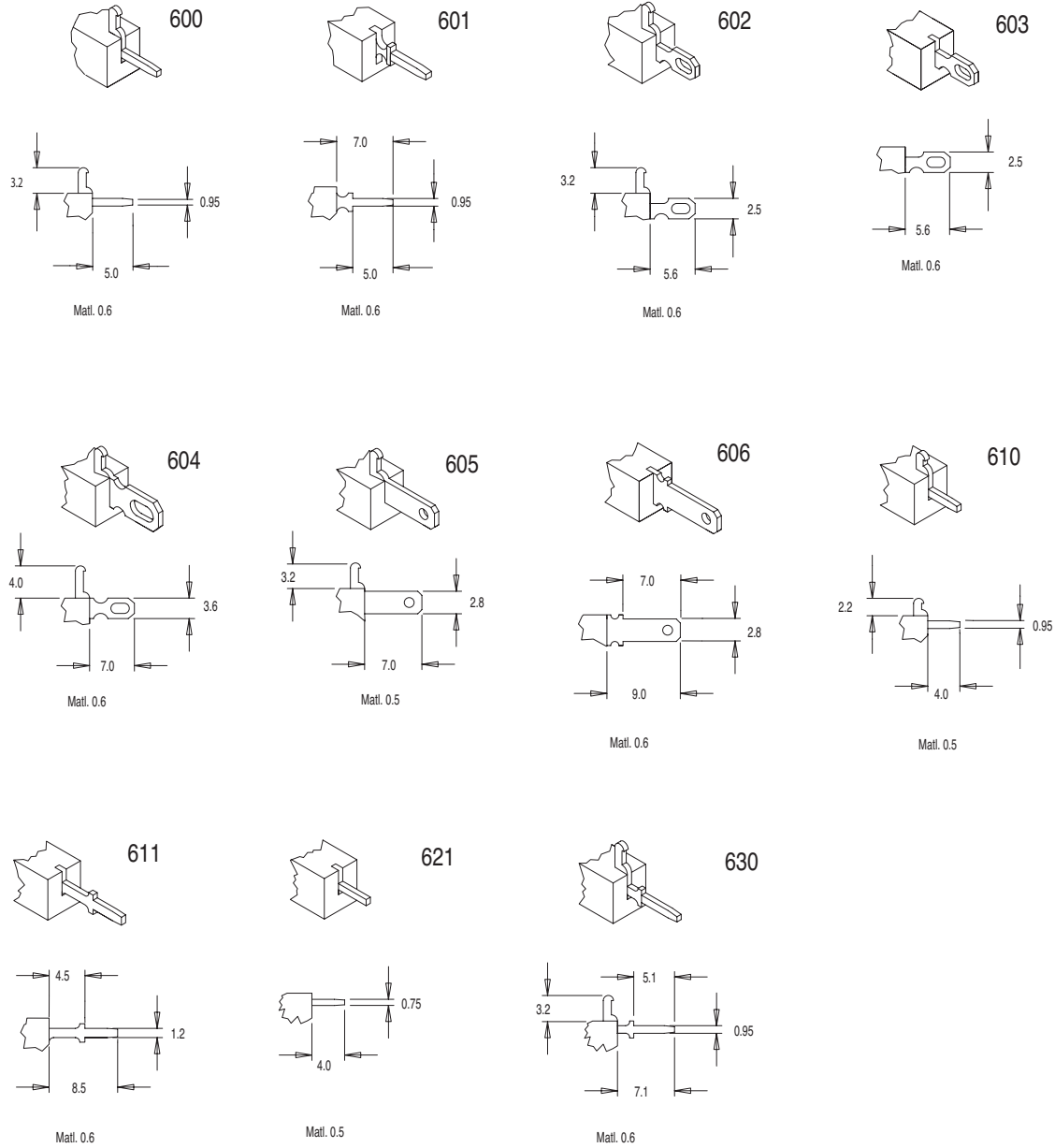

Section 8

Standard materials: CZ108 or CuZn37 brass Solderability test to BS2011: 1981 Dimensions in millimetres All terminals are lead-free

For further technical information please contact sales@milesplatts.co.uk or www.milesplatts.co.uk

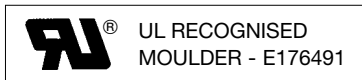

Section 8  
2

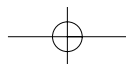



**Terminals**

**TBS 600 RANGE**

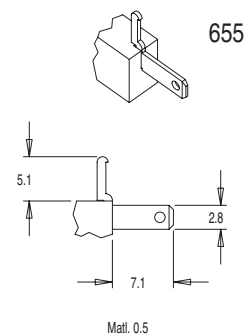
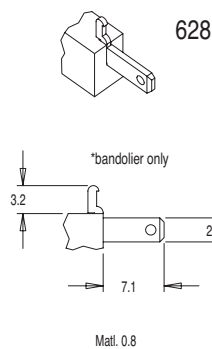
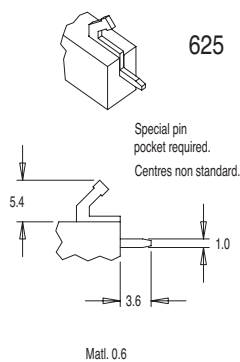
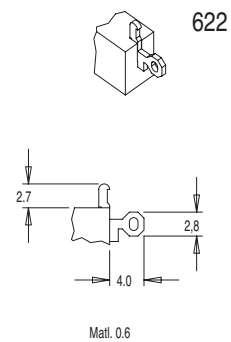
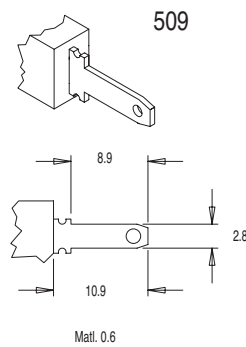
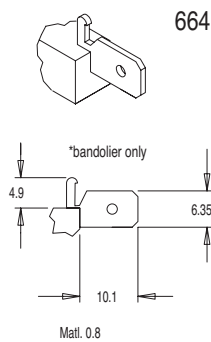
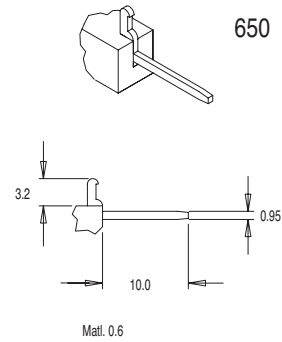
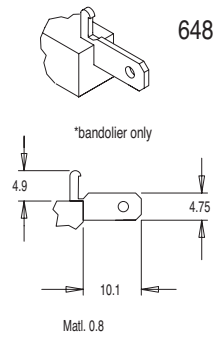
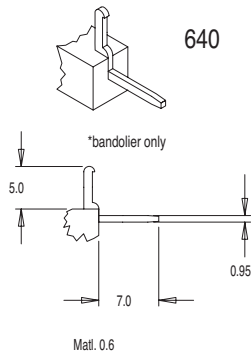

Standard materials: CZ108 or CuZn37 brass Solderability test to BS2011: 1981 Dimensions in millimetres All terminals are lead-free

For further technical information please contact sales  
Tel: +44 (0) 116 262 2593 Fax: +44 (0) 116 253 7889



MILES · PLATTS

Terminals

TBS 900 RANGE

TBS 900

Matl 0.015

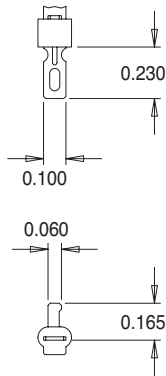
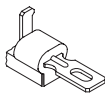

TBS 911

Matl 0.015

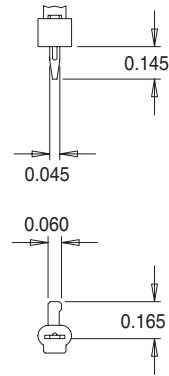

TBS 910

Matl 0.015

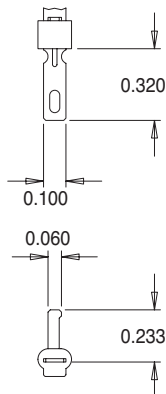
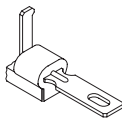

TBS 907

Matl 0.015



Special blind pocket required

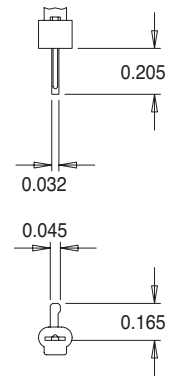

TBS 901

Matl 0.015

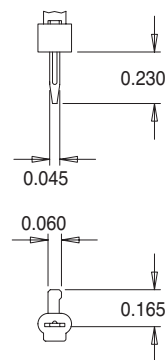

TBS 924

Matl 0.032

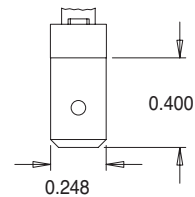

TBS 930

Matl 0.020

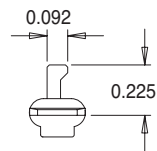
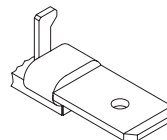

Standard materials: CZ108 or CuZn37 brass Solderability test to BS2011: 1981 Dimensions in inches All terminals are lead-free

Most products are available direct from stock with same day despatch - please contact sales for details



# Terminals

## TBS 900 RANGE

TBS 902

Matl 0.020

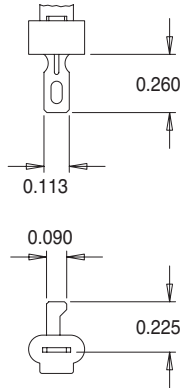
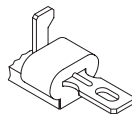

TBS 908

Matl 0.024

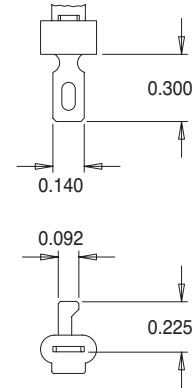
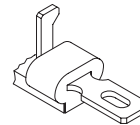

TBS 903

Matl 0.020

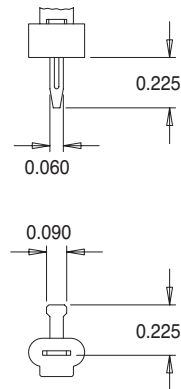
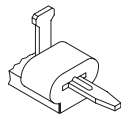

TBS 909

Matl 0.020

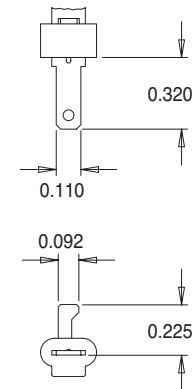
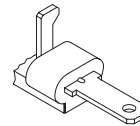

TBS 906

Matl 0.024

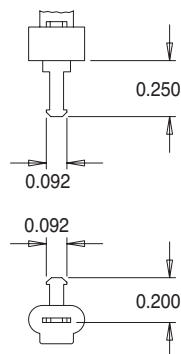
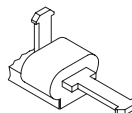

TBS 918

\*bandolier only  
Matl 0.032

TBS 931

Matl 0.020

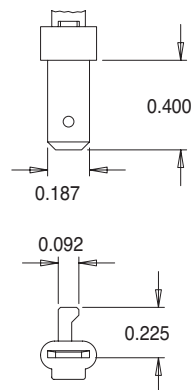
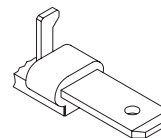

Standard materials: CZ108 or CuZn37 brass Solderability test to BS2011: 1981 Dimensions in inches All terminals are lead-free

Miles-Platts terminals & wire pins are lead-free - all polymers meet the ROHS directive (2002/95/EC). Please refer to website for details.



# Pin Insertion Methods

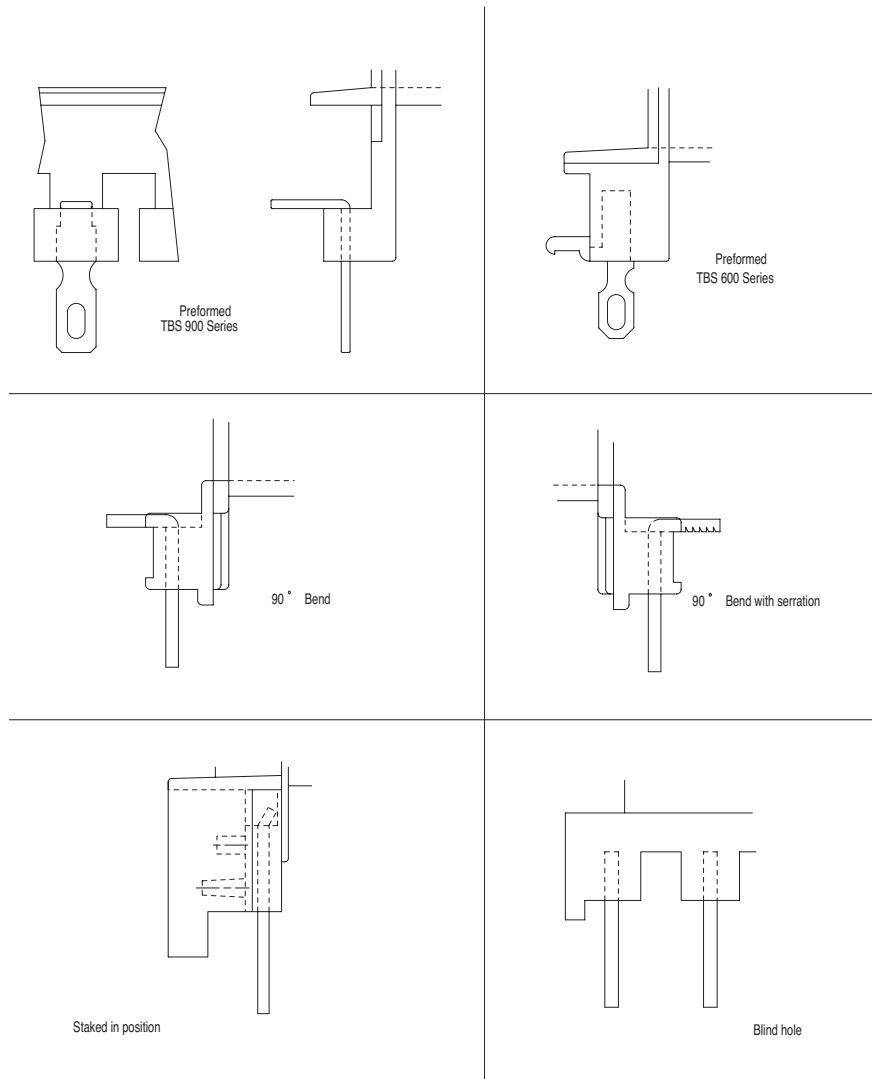

**Section 8**

**Glossary of Terms** - The following is a selected list of industry related terms associated with solderability.

- Activator** A compound added to flux to increase flux efficacy.
- Cold Joint** A commonly used term that refers to a poor quality solder joint.
- Dewetting** Retreat of solder from all or part of joint surfaces, which were initially wetted, leaving an insufficient layer of solder.
- Dip Soldering** The method of soldering adopted by Miles-Platts in which the material to be soldered is fluxed, then dipped into a bath of molten solder.
- Dross** Oxidised solder that forms as a residue in solder baths.
- Efficacy** Term used to describe the level of fluxing activity exhibited by a particular flux.
- Flux** Material used to improve the flow properties of molten solder and the wetting of metallic substrates.
- Liquidus** The temperature at which an alloy becomes fully liquid.
- Solderability** The term used to measure the ease with which a material may be soldered with a particular combination of solder and flux.
- Tinning** A pre-coating of a metallic surface with molten solder to protect from oxidation and preserve solderability.
- Wetting** Spreading of a coating of molten solder on a metallic substrate and production of an intermetallic compound.

Miles-Platts are technical moulders - we manufacture more than bobbins  
 - please contact sales for details